

INTERNAL BOOK RETURNS CHUTE

INSTALLATION INSTRUCTIONS 2021

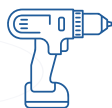

REQUIRED TOOLS & HARDWARE



DRILL
With attachments



SEALANT



SCREW DRIVER
Phillips head



TAPE MEASURE

⚠️ PRE-REQUIRED SITE WORK ⚠️

In order to install a **Raeco Internal Book Returns Chute**, the site must first be inspected by a certified builder or other approved contractor, as a hole is required to be cut through the internal wall of the building. This element of the install falls outside of Raeco's offering and is required to be sourced by the customer. The following steps are the recommended specifications for the chute hole and its cladding, and are intended as a guide for the contractor.

1 MARK THE HOLE LOCATION

🔑 Mark a **416MMW** × **204MMH** hole in the internal wall, **795 - 945MM** up from the ground level.

Following these dimensions will allow room for **18MM timber cladding** (marked in yellow). It will also achieve a **DDA compliant** returns slot of **1100MMH** or lower. Dimensions will need to be adjusted to suit any parameters outside of this recommendation.

⚠️ Ensure the distance from the **inside floor** level to the bottom of the cut is not smaller than **795MMH** or a large returns trolley (**44002**) will not fit under the depository slide.

⚠️ Maximum compatible wall thickness is: **250MM** thick.

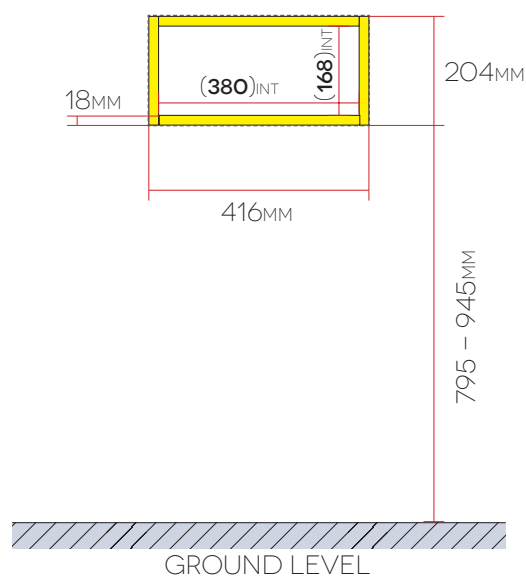

2 CUT & FRAME THE HOLE

With the hole cut through the internal walls, its time to frame the inside of the hole. The timber frame provides the mounting surface for the book returns chute so must be appropriately fixed by the contractor to the studs or structural body of the building. Raeco recommends any gaps be sealed with appropriate interior grade sealant.

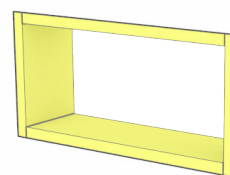

CHUTE INSTALLATION

1 MARK INTERNAL MOUNTING HOLES

Slide the **Internal Returns Chute** into position from the outer side of the wall. While in position, using a marker or pencil, trace the front face plate. This will give you a guide when caulking the face plate to the wall later on. Proceed to mark the (4) mounting holes on the timber frame, two from the outer side and two from the inner side of the wall.

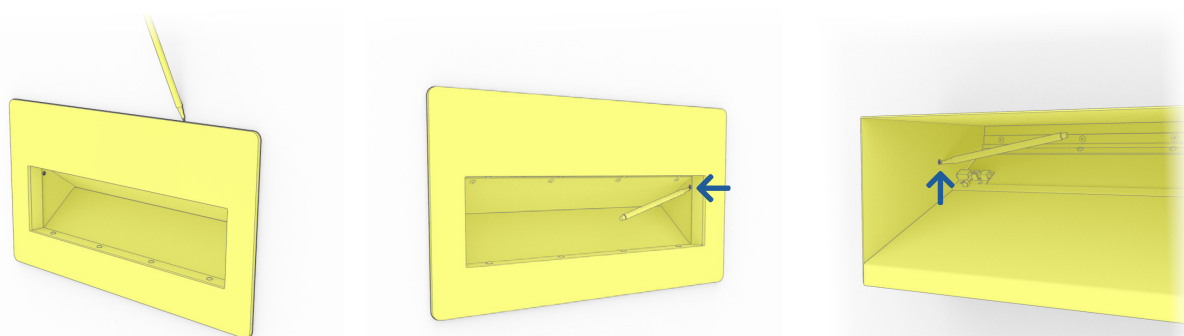

2 DRILL PILOT HOLES FOR MOUNTING

Remove the chute and using a Drill with a 3mm timber bit, drill the (4) previous marked pilot holes for the mounting hardware.

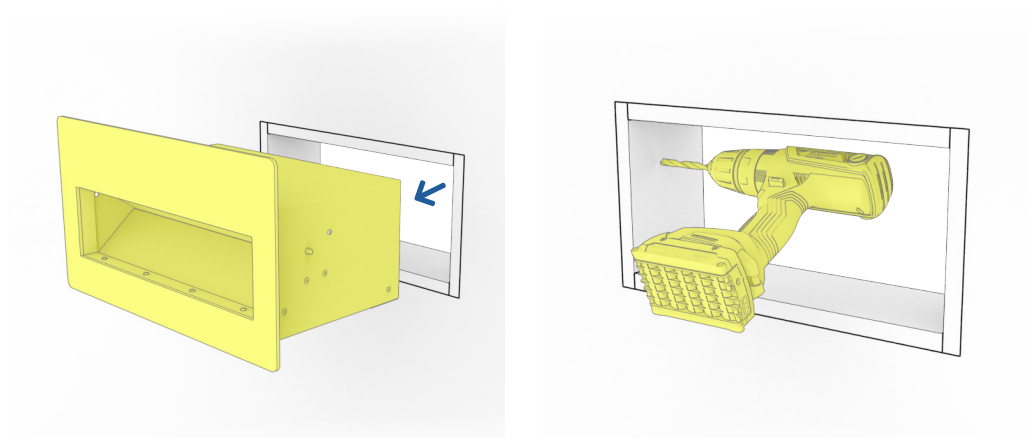

3 CAULK & SEAL FACEPLATE

Using a caulking gun and some interior grade sealant, trace the marked faceplate line on the exterior wall. Next slide the chute back into place, ensuring contact between the sealant, faceplate and wall. Clean-up any overflow or caulking imperfections.

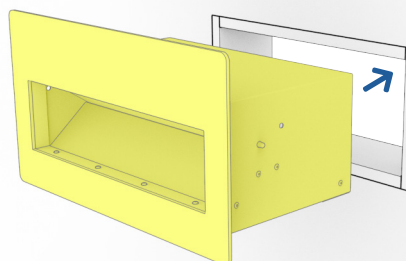
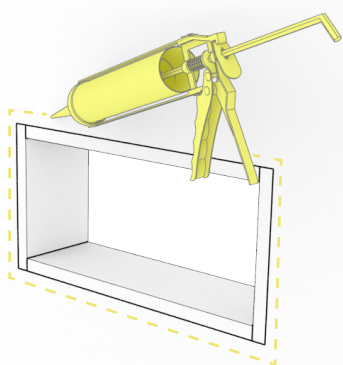

4 SECURE CHUTE IN PLACE

Fasten the chute in place with the hardware provided, through the previously marked and drilled pilot holes.

Mounting directly to timber frame:

- (4) 14G x 1,¼" : **98001**
- (4) 23mm OD Flat Washer : **85429**

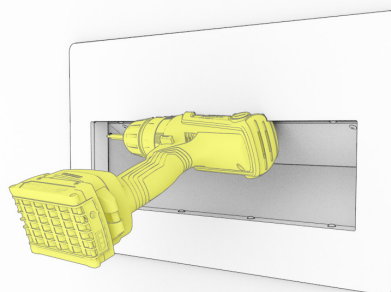
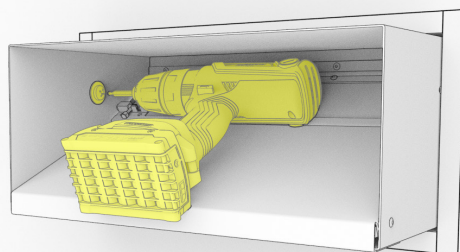

5 CAULK & SEAL REAR FACE PLATE

With the chute now securely fixed in place, its time to caulk the back side of the rear faceplate and slide into place, around the chute body from the internal wall side.

Optional - Fasten the rear faceplate to the wall with the remaining (4) 14G x 1,¼" : 98001 through the holes provided.

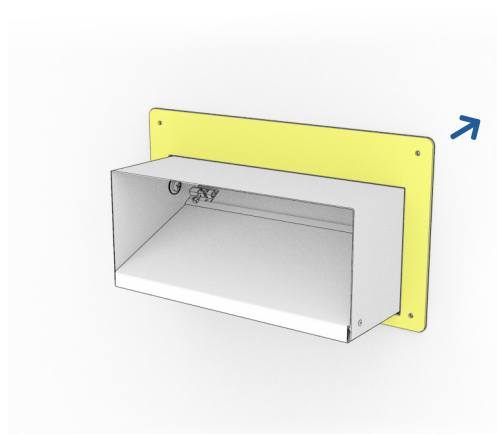
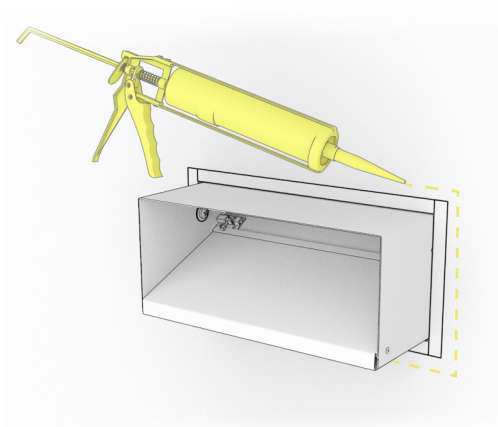

HARDWARE GUIDE (44040)



(85429) : Washer Flat 23mm DIA



(98001) : 14G x 1,¼" Screw